

## Windham Town Report

## Property Owner

**Name:** SCOTT JOHN A & SCOTT ALICIA A**Mailing Address:** PO BOX 1515  
WINDHAM, ME 04062**Parcel Use:** SINGLE FAM

## Property Information

**Physical Address:** 26 VISTA DR**Map/Block/Lot/Unit:** 30-68**Size (Acres):** 0.90

## Additional Information

ZONE	SUBDIVISION	NEIGHBORHOOD
FR	HIGHLAND LAKE VISTA	6015

## Current Assessment

Year	Land	Improvements	Total	Exemptions
2026	\$132,900	\$103,300	\$236,200	\$0

## Land

Use Code	Land Use	Size	Units	Assessed Value
1010	SINGLE FAM	39,204.00	Square Feet	\$132,900

## Deed Transfers

Deed Date	Book	Page	Qualified Sale	Sale Price	Owner
9/11/2024	41237	14	U	N/A	SCOTT JOHN A &
6/1/2023	6402	81	U	N/A	SCOTT MARY - HEIRS OF
8/7/2012	6402	0081	U	\$0	SCOTT MARY
3/7/1984	6402	0081	U	\$29,000	SCOTT STANLEY &

## Residential Card 1 Details

Occupancy	Story	Total Liv	Grade	Year Built	Condition	Beds
Single Family	1	856	02	1950	P	2

<b>Model:</b>	Residential	<b>Style:</b>	RANCH
<b>Roof Cover:</b>	Asph/F Gls/Cmp	<b>Roof Type:</b>	Gable/Hip
<b>Rooms:</b>	<b>Beds: 2 Total: 5</b>	<b>Percent Good:</b>	54%
<b>Interior Wall:</b>	Drywall/Sheet	<b>Plumbing:</b>	<b>Full: 1 Half: 0</b>
<b>Exterior Wall:</b>	Wood Shingle	<b>Heating Fuel:</b>	Oil
<b>Interior Floor:</b>	Carpet	<b>Heating Type:</b>	Hot Water

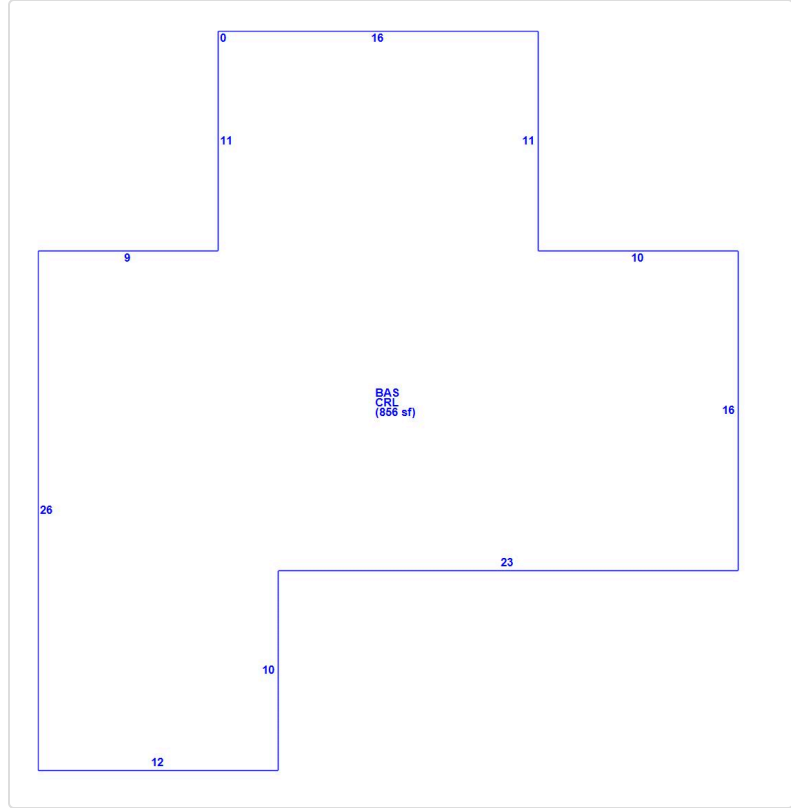

### Building Sub-Areas (sq ft)

Code	Description	Gross Area	Living Area
BAS	First Floor	856	856
CRL	Crawl Space	856	0
<b>Totals</b>		<b>1,712</b>	<b>856</b>

### Outbuildings and Extra Features

Code	Description	Size	Assessed Value
FGR1	GARAGE-AVE	672.00 S.F.	\$13,500
SHD1	SHED FRAME	180.00 S.F.	\$1,400
SHD1	SHED FRAME	194.00 S.F.	\$1,600

<b>Assessment History</b>				
<b>Year</b>	<b>Land</b>	<b>Improvements</b>	<b>Total</b>	<b>Exemptions</b>
2025	\$132,900	\$103,300	\$236,200	\$0
2024	\$132,900	\$103,300	\$236,200	\$0
2023	\$123,900	\$102,000	\$225,900	\$25,000
2022	\$98,000	\$89,800	\$187,800	\$25,000
2021	\$85,100	\$85,100	\$170,200	\$25,000
2020	\$74,500	\$75,000	\$149,500	\$25,000
2019	\$74,500	\$75,000	\$149,500	\$20,000
2018	\$67,000	\$70,200	\$137,200	\$20,000
2017	\$60,400	\$63,500	\$123,900	\$20,000
2016	\$60,400	\$63,500	\$123,900	\$15,000
2015	\$60,400	\$63,500	\$123,900	\$10,000
2014	\$60,400	\$63,500	\$123,900	\$10,000
2013	\$60,400	\$63,500	\$123,900	\$10,000
2012	\$60,400	\$63,500	\$123,900	\$10,000
2011	\$60,400	\$63,500	\$123,900	\$10,000
2010	\$75,300	\$67,000	\$142,300	\$10,000
2009	\$75,300	\$67,000	\$142,300	\$13,000
2008	\$75,300	\$67,000	\$142,300	\$13,000
2007	\$75,300	\$67,000	\$142,300	\$13,000
2006	\$75,300	\$67,000	\$142,300	\$13,000
2003	\$39,800	\$0	\$90,800	\$0

## Map



Copyright Text: Source: Esri, Maxar, Earthstar Geographics, and the GIS User Community

## Not a Legal Document

Subject to terms and conditions  
[www.actDataScout.com](http://www.actDataScout.com)