

Notification: 10300638723

Work Order: 801000274155

CENTRAL MAINE POWER COMPANY
APPLICATION FOR POLE LOCATION OR UNDERGROUND LOCATION

1 of 3

In the City/Town of: Windham, Maine

To the: City
 Town

County of: Cumberland, Maine

Central Maine Power hereby applies for permission to:

Construct and maintain poles together with attached facilities and appurtenances upon, along or across certain streets and highways in said City/Town as described below.

Construct and maintain buried cables, conduits, manholes and handholes, together with wire and cables, transformers, cutouts, and other equipment therein, under, along, and across certain streets and highways in said City/Town as described below.

Central Maine Power Company and Northern New England Telephone Operations LLC

jointly apply for permission to construct and maintain poles together with attached facilities and appurtenances upon, along or across certain streets and highways in said City/Town as described below.

1. Starting Point: Corner of Morgan Lane and Land of Nod

2. Road (State & CMP): Land of Nod

3. Direction: Westerly from Morgan Lane

4. Distance: +/- 50 feet

5. Number of Poles: 1

Overhead wires shall have a minimum clearance of 18 feet over the public highway and be constructed to conform with the requirements of the National Electric Safety Code.

Buried cable facilities shall be placed at a minimum depth of 36 inches under pavement and 30 inches elsewhere and be constructed to conform with the requirements of the National Electric Safety Code.

Any person, firm, or corporation to be adversely affected by this proposed location shall file a written objection with the State Department of Transportation, City, Town or County stating the cause of said objection within fourteen (14) days after the publication of this notice or ninety (90) days after installation of facilities without publication.

Public Notice of this application has been given by publishing the text of the same

Not Published

In: []

On: []

CENTRAL MAINE POWER COMPANY

Northern New England Telephone Operations LLC

By: Jay Agreste

Date: Jan 27, 2020

By: [Signature]

Date: 1/27/20

[Signature] ROSS THERIAULT - RIGHT OF WAY

CENTRAL MAINE POWER COMPANY

SKETCH TO ACCOMPANY APPLICATION FOR POLE OR UNDERGROUND LOCATIONS

City/Town: Windham

Date: Jan 27, 2020

Street: Land of Nod

By: Jay Agreste

Facilities to consist of wood poles and appurtenances with a minimum clearance of wire and cables not less than 21 feet over the public highway, and/or underground facilities to consist of buried cables, conduits, transformers and manholes for operation at 7200 volts to ground single phase. Construction to be suitable for future operation at a voltage not to exceed 22KV to ground single phase. Right-of-way limits indicated are based on the best field information available. Poles/Pads are staked. For further information call: Jay Agreste at Central Maine Power Company tel: 629-1424 . Pole/Pad spans shown are approximate.

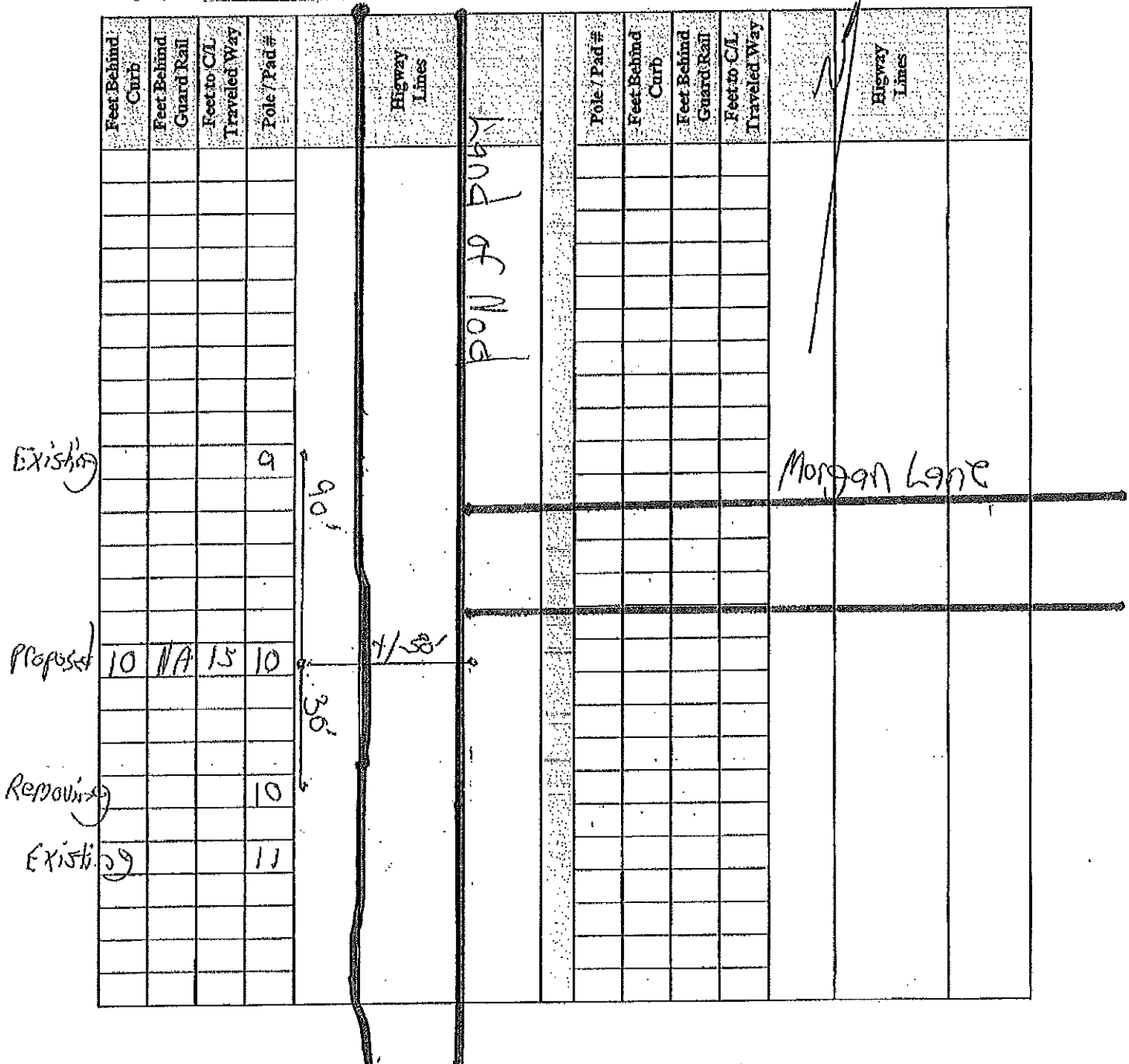

Notification: 10300638723

Work Order: 801000274165

3 of 3

LOCATION PERMIT

Upon the Application of Center Maine Power Company and Northern New England Telephone Operations LLC,

dated Jan 27, 2020, asking for permission, in accordance with law, to construct and maintain poles, buried cables, conduits, and transformers, together with attached facilities and appurtenances over, under, along or across certain highways and public roads in the location described in said application, permission is hereby given to construct, reconstruct, maintain and relocate in substantially the same location, said facilities and appurtenances in the City / Town of Windham,

approximately located as follows:

- 1. Starting Point: Corner of Morgan Lane and Land of Nod
- 2. Road (State & CMP): Land of Nod
- 3. Direction: Westerly from Morgan Lane
- 4. Distance: +/- 50 feet
- 5. Number of Poles: 1

Facilities shall consist of wood poles and appurtenances with a minimum of wire and cable not less than 18 feet over the public highway and/or buried cables or conduit and appurtenances placed a minimum depth of 36 inches under pavement and 30 inches elsewhere, all in a manner conforming to the National Electric Safety Code.

By: _____

By: _____

By: _____

By: _____

By: _____

Municipal Officers

Office of the _____

Received and Recorded in Book _____, Page _____

Attest: _____

Clerk