



The Contractor shall verify and be responsible for all dimensions. DO NOT scale the drawing - any errors or omissions shall be reported to Stantec without delay.

The Copyrights to all designs and drawings are the property of Stantec. Reproduction or use for any purpose other than that authorized by Stantec is forbidden.

Haley & Aldrich (Geotechnical)
75 Washington Avenue, Suite 1A
Portland, Maine 04101

Plisga & Day Land Surveyors (Surveyor)
72 Main Street
Bangor, Maine 04401

Independent Archaeological Consulting, LLC
(Archaeologist)
801 Islington Street, Suite 31
Portsmouth, New Hampshire 03801

Diana's CADD Service, LLC (Drafting)
P. O. Box 372
Jackman, Maine 04945

1	ISSUED FOR CLIENT REVIEW	AMG	DDA	21.02.25
Revision		By	Appd.	YY.MM.DD

File Name: 195211595_fb_storage_bldg	AMG	DDA	DDA	FEB 2021
	DWN.	CHKD.	DSGN.	DATE

RSU #14

WINDHAM SCHOOL CAMPUS
STORAGE BUILDING CONCEPT

WINDHAM, MAINE

Title

FIGURE 1 - AERIAL

Project No.
195211595

Scale
1" = 20'

Sheet

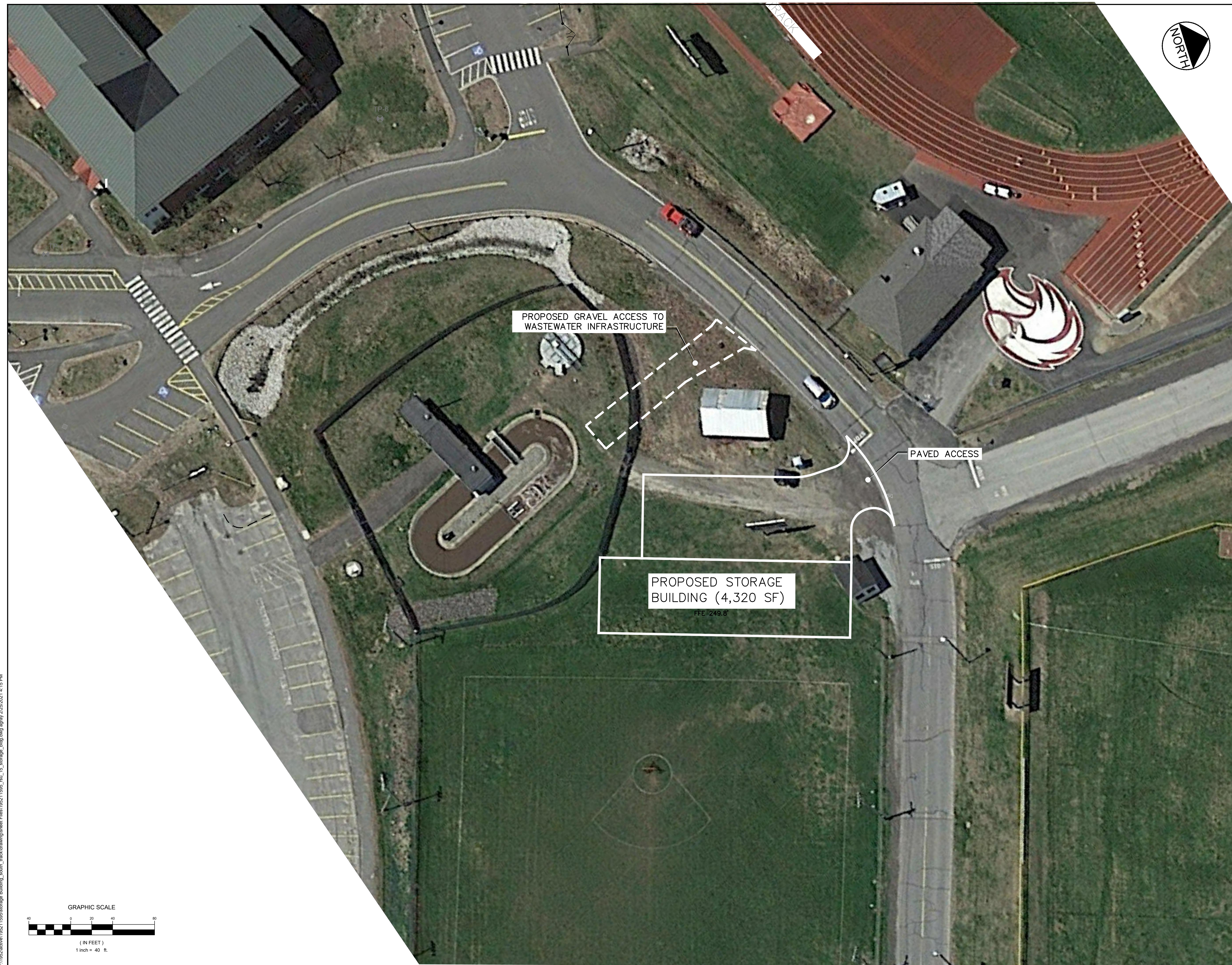

\\1952\active\1952\1595\storage\Building_south_track\drawing\sheet Files\1952\1595_rsu_15_storage_bldg.dwg agray 2/25/2021 4:15 PM