

**TOWN OF WINDHAM
ADDENDUM TO LIQUOR LICENSE APPLICATION**

Applicant: Dena's Lobster House and Tavern

REVIEW BY POLICE CHIEF

I have made a search of our records for police contacts with the above listed Applicant and find:

✓

No remarkable incidents during the past 12 months that would jeopardize a liquor license application.

I request permission to personally address the Town Council for public record. (Relevant materials attached)

Signed: 

Date: 12/11/18

REVIEW BY COMMUNITY DEVELOPMENT DIRECTOR

✓

The applicant's establishment is in conformance with The Town's Land Use Code and has an occupancy permit

I request permission to personally address the Town Council For public record. (Relevant materials attached)

Signed: 

Date: 12/13/18

BUREAU OF ALCOHOL BEVERAGES AND LOTTERY OPERATIONS
DIVISION OF LIQUOR LICENSING AND ENFORCEMENT
8 STATE HOUSE STATION, AUGUSTA, ME 04333-0008
10 WATER STREET, HALLOWELL, ME 04347
TEL: (207) 624-7220 FAX: (207) 287-3434
EMAIL INQUIRIES: MAINELIQUOR@MAINE.GOV

DIVISION USE ONLY	
License No:	
Class:	By:
Deposit Date:	
Amt. Deposited:	
Cash Ck Mo:	

NEW application: ☐ Yes ☒ No

PRESENT LICENSE EXPIRES

12/31/18

INDICATE TYPE OF PRIVILEGE: ☒ MALT ☒ VINOUS ☒ SPIRITUOUS

INDICATE TYPE OF LICENSE:

- | | | |
|---|--|--|
| <input type="checkbox"/> RESTAURANT (Class I,II,III,IV) | <input checked="" type="checkbox"/> RESTAURANT/LOUNGE (Class XI) | <input type="checkbox"/> CLASS A LOUNGE (Class X) |
| <input type="checkbox"/> HOTEL (Class I,II,III,IV) | <input type="checkbox"/> HOTEL, FOOD OPTIONAL (Class I-A) | <input type="checkbox"/> BED & BREAKFAST (Class V) |
| <input type="checkbox"/> CLUB w/o Catering (Class V) | <input type="checkbox"/> CLUB with CATERING (Class I) | <input type="checkbox"/> GOLF COURSE (Class I,II,III,IV) |
| <input type="checkbox"/> TAVERN (Class IV) | <input type="checkbox"/> QUALIFIED CATERING | <input type="checkbox"/> OTHER: _____ |

REFER TO PAGE 3 FOR FEE SCHEDULE

ALL QUESTIONS MUST BE ANSWERED IN FULL

Corporation Name: 302 Club LLC		Business Name (D/B/A) Dena's Lobsterhouse and Tavern	
APPLICANT(S) -(Sole Proprietor)		DOB:	
DOB:		Physical Location: 165 Roosevelt Trail	
DOB:		City/Town Windham	State ME
DOB:		Zip Code 04062	
Address PO Box 388		Mailing Address PO Box 388	
City/Town Windham	State ME	City/Town Windham	State ME
Zip Code 04062	Zip Code 04062	Zip Code 04062	Zip Code 04062
Telephone Number 207-892-1302	Fax Number _____	Business Telephone Number 207-892-1302	Fax Number _____
Federal I.D. # 26-3898479		Seller Certificate #: or Sales Tax #: 1172952	
Email Address: Please Print dena.witheya@gmail.com		Website:	

If business is NEW or under new ownership, indicate starting date: _____

Requested inspection date: _____

Business hours:

Tues-Sun 11:05am-11:05pm Fri-Sat 11AM-1AM

- If premise is a Hotel or Bed & Breakfast, indicate number of rooms available for transient guests: _____
- State amount of gross income from period of last license: ROOMS \$ _____ FOOD \$ _____ LIQUOR \$ _____
- Is applicant a corporation, limited liability company or limited partnership? YES ☒ NO ☐
If Yes, please complete the Corporate Information required for Business Entities who are licensees.
- Do you own or have any interest in any another Maine Liquor License? ☐ Yes ☒ No
If yes, please list License Number, Name, and physical location of any other Maine Liquor Licenses.

 License # Name of Business (Use an additional sheet(s) if necessary.)

 Physical Location City / Town

The Division of Liquor Licensing & Enforcement is hereby authorized to obtain and examine all books, records and tax returns pertaining to the business, for which this liquor license is requested, and also such books, records and returns during the year in which any liquor license is in effect.

NOTE: "I understand that false statements made on this form are punishable by law. Knowingly supplying false information on this form is a Class D offense under the Criminal Code, punishable by confinement of up to one year or by monetary fine of up to \$2,000 or both."

Dated at: Windham, ME on November 9, 20 18
Town/City State Date
Signature of Applicant or Corporate Officer(s) **Please sign in blue ink** Signature of Applicant or Corporate Officer(s)
Kenneth S Ray Dena W Hthey
Print Name Print Name

FEE SCHEDULE

FILING FEE: (must be included on all applications)..... \$ 10.00

- Class I** Spirituous, Vinous and Malt \$ 900.00
CLASS I: Airlines; Civic Auditoriums; Class A Restaurants; Clubs with catering privileges; Dining Cars; Golf Clubs; Hotels; Indoor Ice Skating Clubs; Indoor Tennis Clubs; Vessels; Qualified Caterers; OTB.
- Class I-A** Spirituous, Vinous and Malt, Optional Food (Hotels Only) \$1,100.00
CLASS I-A: Hotels only that do not serve three meals a day.
- Class II** Spirituous Only \$ 550.00
CLASS II: Airlines; Civic Auditoriums; Class A Restaurants; Clubs with catering privileges; Dining Cars; Golf Clubs; Hotels; Indoor Ice Skating Clubs; Indoor Tennis Clubs; and Vessels.
- Class III** Vinous Only \$ 220.00
CLASS III: Airlines; Civic Auditoriums; Class A Restaurants; Clubs with catering privileges; Dining Cars; Golf Clubs; Hotels; Indoor Ice Skating Clubs; Indoor Tennis Clubs; Restaurants; Vessels; Pool Halls; and Bed and Breakfasts.
- Class IV** Malt Liquor Only \$ 220.00
CLASS IV: Airlines; Civic Auditoriums; Class A Restaurants; Clubs with catering privileges; Dining Cars; Golf Clubs; Hotels; Indoor Ice Skating Clubs; Indoor Tennis Clubs; Restaurants; Taverns; Pool Halls; and Bed and Breakfasts.
- Class V** Spirituous, Vinous and Malt (Clubs without Catering, Bed & Breakfasts) \$ 495.00
CLASS V: Clubs without catering privileges.
- Class X** Spirituous, Vinous and Malt – Class A Lounge \$2,200.00
CLASS X: Class A Lounge
- Class XI** Spirituous, Vinous and Malt – Restaurant Lounge \$1,500.00
CLASS XI: Restaurant/Lounge; and OTB.

UNORGANIZED TERRITORIES \$10.00 filing fee shall be paid directly to County Treasurer. All applicants in unorganized territories shall submit along with their application evidence of payment to the County Treasurer.

Bureau of Alcoholic Beverages and Lottery Operations
Division of Liquor Licensing & Enforcement
8 State House Station, Augusta, ME 04333-0008
10 Water Street, Hallowell, ME 04347
Tel: (207) 624-7220 Fax: (207) 287-3434
Email Inquiries: MaineLiquor@maine.gov

DIVISION USE ONLY	
<input type="checkbox"/>	Approved
<input type="checkbox"/>	Not Approved
BY:	

ON PREMISE DIAGRAM

In an effort to clearly define your license premise and the area that consumption and storage of liquor is allowed. The Division requires all applicants to submit a diagram of the premise to be licensed in addition to a completed license application.

Diagrams should be submitted on this form and should be as accurate as possible. Be sure to label the areas of your diagram including entrances, office area, kitchen, storage areas, dining rooms, lounges, function rooms, restrooms, decks and all areas that you are requesting approval from the Division for liquor consumption.

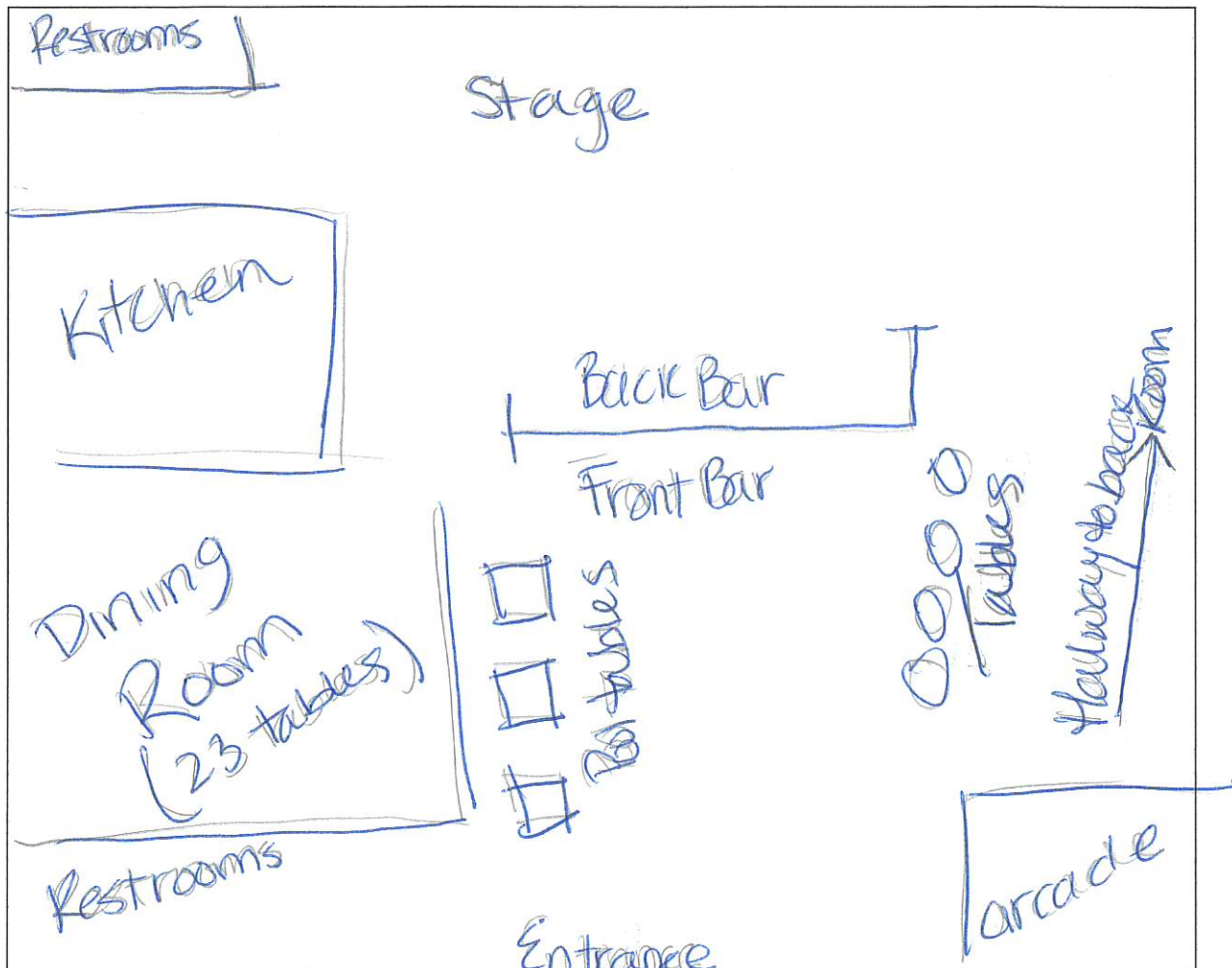

5. Do you permit dancing or entertainment on the licensed premises? YES ☒ NO ☐
6. If manager is to be employed, give name: Dena Withey
7. Business records are located at: 765 Roosevelt Trail Windham ME 04062
8. Is/are applicant(s) citizens of the United States? YES ☒ NO ☐
9. Is/are applicant(s) residents of the State of Maine? YES ☒ NO ☐
10. List name, date of birth, and place of birth for all applicants, managers, and bar managers. Give maiden name, if married:
Use a separate sheet of paper if necessary.

Name in Full (Print Clearly)	DOB	Place of Birth
Dena Withey	04-7-75	Kansas
Kenneth Ray	03-14-58	Leicester, ME
Residence address on all of the above for previous 5 years (Limit answer to city & state)		
10 Huckleberry Ln Windham, ME 04062 - Dena		
65 Old Pike Road Cornish, ME 04020		
Cumberland, ME - Kenneth		

11. Has/have applicant(s) or manager ever been convicted of any violation of the law, other than minor traffic violations, of any State of the United States? YES ☐ NO ☒
- Name: _____ Date of Conviction: _____
- Offense: _____ Location: _____
- Disposition: _____ (use additional sheet(s) if necessary)
12. Will any law enforcement official benefit financially either directly or indirectly in your license, if issued?
Yes ☐ No ☒ If Yes, give name: _____
13. Has/have applicant(s) formerly held a Maine liquor license? YES ☒ NO ☐
14. Does/do applicant(s) own the premises? Yes ☒ No ☐ If No give name and address of owner: _____
15. Describe in detail the premises to be licensed: (On Premise Diagram Required) see attached
16. Does/do applicant(s) have all the necessary permits required by the State Department of Human Services?
YES ☒ NO ☐ Applied for: _____
17. What is the distance from the premises to the **NEAREST** school, school dormitory, church, chapel or parish house, measured from the main entrance of the premises to the main entrance of the school, school dormitory, church, chapel or parish house by the ordinary course of travel? 1 mile
Which of the above is nearest? Manchester Elementary School / Church
18. Have you received any assistance financially or otherwise (including any mortgages) from any source other than yourself in the establishment of your business? YES ☐ NO ☒
- If YES, give details: _____



Division of Alcoholic Beverages and Lottery
Operations
Division of Liquor Licensing and Enforcement

**Corporate Information Required for
Business Entities Who Are Licensees**

For Office Use Only:

License #: _____

SOS Checked: _____

100% Yes ☐ No ☐

Questions 1 to 4 must match information on file with the Maine Secretary of State's office. If you have questions regarding this information, please call the Secretary of State's office at (207) 624-7752.

Please clearly complete this form in its entirety.

1. Exact legal name: 302 Club LLC
2. Doing Business As, if any: Dennis Waterhouse + Tavern
3. Date of filing with Secretary of State: 2008 State in which you are formed: Maine
4. If not a Maine business entity, date on which you were authorized to transact business in the State of Maine:

5. List the name and addresses for previous 5 years, birth dates, titles of officers, directors and list the percentage ownership: (attach additional sheets as needed)

NAME	ADDRESS (5 YEARS)	Date of Birth	TITLE	Ownership %
Kenneth S Ray	51 Foreside Rd Cumberland Foreside	3/14/58		50
Dena Withey	Current - P.O. Box 376 Windham Prev. P.O. Box 113 - Cornish	4/7/75		50

(Stock ownership in non-publicly traded companies must add up to 100%.)

6. If Co-Op # of members: _____ (list primary officers in the above boxes)

7. Is any principal person involved with the entity a law enforcement official?

Yes ☐ No ☒ If Yes, Name: _____ Agency: _____

8. Has any principal person involved in the entity ever been convicted of any violation of the law, other than minor traffic violations, in the United States?

Yes ☐ No ☒

9. If Yes to Question 8, please complete the following: (attached additional sheets as needed)

Name: _____

Date of Conviction: _____

Offense: _____

Location of Conviction: _____

Disposition: _____

Signature:

Signature of Duly Authorized Person

Date

11/9/18

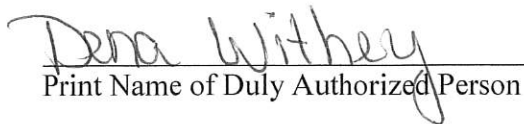
Print Name of Duly Authorized Person

Submit Completed Forms to:

Bureau of Alcoholic Beverages
Division of Liquor Licensing and Enforcement
8 State House Station, Augusta, Me 04333-0008 (Regular address)
10 Water Street, Hallowell, ME 04347 (Overnight address)
Telephone Inquiries: (207) 624-7220 Fax: (207) 287-3434
Email Inquiries: MaineLiquor@Maine.gov