

- LEGEND**
- 1234/56 BOOK & PAGE IN THE CLIMBERLAND COUNTY REGISTRY OF DEEDS
 - SET 5/8 inch IRON NAIL
 - POLE
 - STONEWALL
 - EDGE OF PAVEMENT
 - BARS WIRE
 - IRON PIPE FOUND
 - OVERHEAD WIRES
 - GRAVEL DRIVE & PARKING AREA
 - BULBONS
 - DIRECTION OF FLOW
 - BROOK
 - OVERHEAD WIRES
 - CULVERT
 - CONTOUR LINE
 - TP LOCATION
 - PROPOSED SUBSURFACE WASTEWATER DISPOSAL AREA

NOTES

1 TP 3 WAS ASSUMED TO BE ON REAR LOT VERIFY PARKING SOL CONDITIONS. ACTUAL PLOTTING BASED ON FRONT LOT (84,702 sq. ft.). PROPOSED SYSTEM SITE ON REAR LOT (308,863 sq. ft.) IS BASED ON PROJECTION OF FAVORABLE SOLS AND SITE CONDITIONS IN THE VICINITY OF TP3. ADDITIONAL TEST PIT NEEDED BEFORE FINAL DESIGN AND LAYOUT.

2) PROPOSED LEACH FIELDS SHALL BE LOCATED TO MEET CRITERIA SET FORTH BY SEVEE & MAHER ENGINEERS, INC., REPORT DATED 1-12-1990

LAND NOW OR FORMERLY RUTH E. REEVE 669/282

NET RESIDENTIAL CALCULATION

TOTAL AREA	= 18.498 acres
WET AREA	= 2.69 acres
SLOPES	= 0
ROAD	= 0
FLOOD HAZARD	= 0
TOTAL NET AREA	= 15.8 acres

SOURCE OF SOIL MAPPING
 SOIL SURVEY, CLIMBERLAND COUNTY, MAINE
 U. S. DEPARTMENT OF AGRICULTURE,
 SOIL CONSERVATION SERVICE, IN COOPERATION WITH
 MAINE AGRICULTURAL EXPERIMENT STATION
 ISSUED AUGUST 1974

Wc = WOODRIDGE FINE SANDY LOAM, 8 TO 18 PERCENT SLOPES
 Pbc = FAXTON FINE SANDY LOAM, 8 TO 18 PERCENT SLOPES
 Pbs = FAXTON FINE SANDY LOAM, 3 TO 8 PERCENT SLOPES
 Ss = SCANTIC SILT LOAM

DATUM: NGVD 29
 BENCH MARK: PFC-302-M-1989

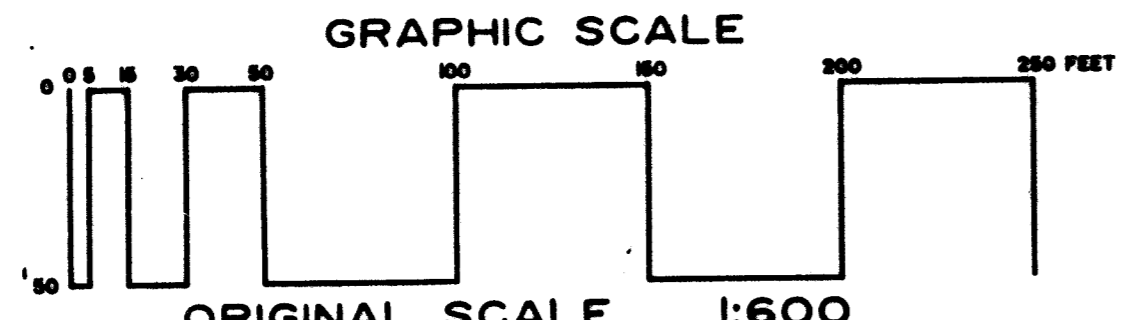
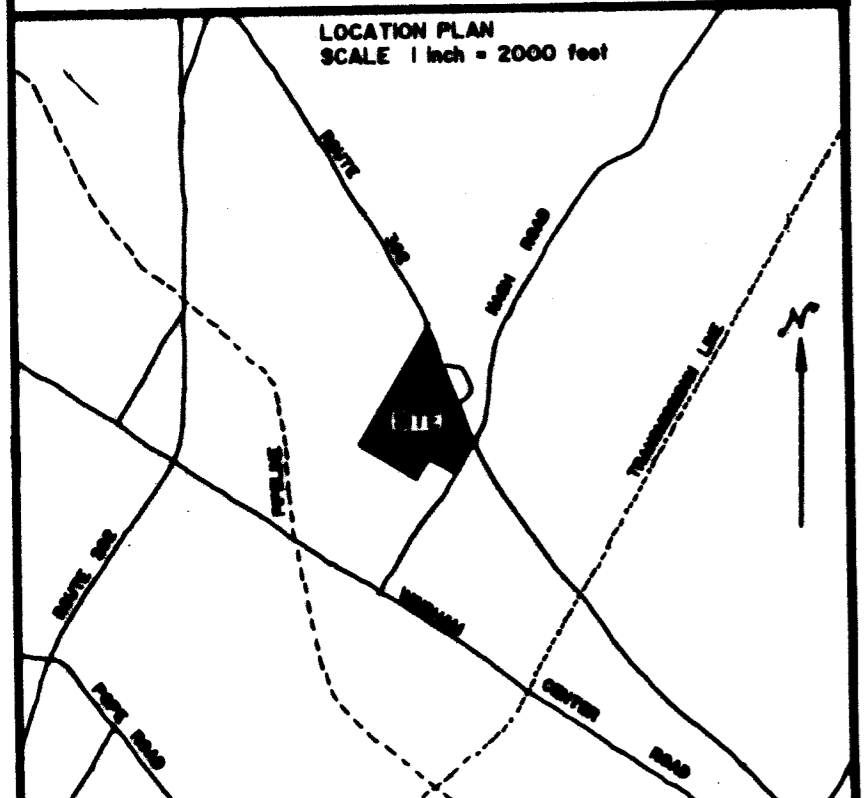

OWNER OF RECORD: V. P. ASSOCIATES
 7575/12
 ZONING = FARM
 AREA = 18.498 acres

PLAN APPROVED
 TOWN OF WINDHAM
 PLANNING BOARD
 DATE 4-23-90
are K Moore
James R. Saunders
Richard L. Long
Douglas C. Johnson

STATE OF MAINE, CLIMBERLAND ss
 REGISTRY OF DEEDS
 RECEIVED NOV 11 1990
 AT 2:34 PM AND RECORDED
 IN PLANBOOK 187 PAGE 22
 ATTEST: *[Signature]*
 REGISTER

TO THE BEST OF MY KNOWLEDGE,
 THIS SURVEY, HEREON, CONFORMS TO
 THE MAINE BOARD OF REGISTRATION
 FOR LAND SURVEYOR STANDARDS FOR
 CATEGORY 1 AND CONDITION III.

James C. Louzier PLS 1076
 THIS PLAN IS MADE FOR THE PURPOSE
 OF RECORDING AND NOT CONVEYANCE

STANDARD BOUNDARY SURVEY

11-29-1989	ADD LOT IRON	11-29-1989	ADJUSTMENT OF PROPOSED DRIVEWAY	11-29-1989	SEE DATA AND NOTES BY ALBERT FRICK, JR. 123	11-29-1989	CONTOUR LINE	11-29-1989	ADJUSTMENT OF DRIVEWAY & LOCATING PLAN	11-29-1989	REVISION	
FILE	375	DATE	4/23/90	BOOK	481	SCALE	1 inch = 80 feet	DATE	SEPT. 01, 1990	AUG. 1990	DRAWN BY	MBY
<p>PLAN OF LAND SUBURBAN PINES MOTEL U. S. ROUTE 302 & NASH ROAD WINDHAM, MAINE</p> <p>MADE FOR V. P. ASSOCIATES 547 MAIN STREET WESTBROOK, MAINE</p> <p>James C. Louzier PLS 1076 Land Surveying Consultant PO Box 234 So. Windham, Maine 04082 Telephone (607) 598-3774</p>												