

BUSQUE QUARRY

WINDHAM, MAINE
MSHA LICENSE 17-00795
MDEP LICENSE L-602

CONDITIONS OF APPROVAL:

1. APPROVAL IS DEPENDANT UPON, AND LIMITED TO, THE PROPOSALS AND PLANS CONTAINED IN THE APPLICATION DATED AUGUST 30, 2010, AND SUPPORTING DOCUMENTS AND ORAL REPRESENTATIONS SUBMITTED AND AFFIRMED BY THE APPLICANT, AND CONDITIONS, IF ANY, IMPOSED BY THE PLANNING BOARD, AND ANY VARIATION FROM SUCH PLANS, PROPOSALS AND SUPPORTING DOCUMENTS AND REPRESENTATIONS ARE SUBJECT TO REVIEW AND APPROVAL BY THE PLANNING BOARD OR THE TOWN PLANNER IN ACCORDANCE WITH SECTION 814 OF THE LAND USE ORDINANCE.
2. THE APPLICANT SHALL IMPLEMENT THE RECOMMENDATIONS ON PAGE 6 OF THE SWEET ASSOCIATES REVISED HYDROGEOLOGICAL INVESTIGATION DATED MAY 25, 2007. THESE INCLUDE GROUNDWATER LEVEL MONITORING, INSTALLATION OF A DRILLED WELL FOR THE EXISTING RESIDENCE, AND GROUNDWATER QUALITY AND QUANTITY TESTING.
3. UNLESS PROHIBITED BY STATE OR FEDERAL LAW, THE "DIESEL SPILL PREVENTION AND COUNTERMEASURE PLAN" MUST BE REVISED SO THAT THE WINDHAM FIRE AND RESCUE DEPARTMENT IS THE FIRST POINT OF CONTACT IN THE EVENT OF AN EMERGENCY.
4. THE MATURE TREES OUTSIDE OF THE TREE LINE AREA DEPICTED ON SHEET 3 OF 8 SHALL NOT BE REMOVED DURING THE LIFETIME OF THE QUARRY OPERATION. THIS DOES NOT INCLUDE MATURE TREES THAT POSE A SAFETY HAZARD DUE TO DEATH, DISEASE OR BLOWDOWN.
5. THIS APPROVAL IS LIMITED TO THE QUARRY AND RECLAMATION PLANS. ANY PROPOSED FUTURE USES OF THE RECLAIMED AREA OR PROPERTY WILL REQUIRE APPROVALS AT THE TIME THAT THEY ARE PROPOSED AND MUST COMPLY WITH ZONING AND OTHER LAND USE REQUIREMENTS IN EFFECT AT THE TIME THAT THOSE APPROVALS ARE SOUGHT.
6. NO CONTAMINATED SOIL SHALL BE USED IN THE FILLING OF LAND TO ACCOMPLISH THE REQUIRED RECLAMATION PLAN.
7. NO GROUND VIBRATION SHALL BE PRODUCED WHICH DOES NOT MEET THE STANDARDS CONTAINED IN 38 M.R.S.A. SECTION 490-214I. FURTHERMORE, THE 2.0 RPM STANDARD OF 38 M.R.S.A. SECTION 490-214I SHALL BE LIMITED TO THE PROPERTY LINE, RATHER THAN THE NEAREST INHABITABLE STRUCTURE NOT OWNED OR CONTROLLED BY THE DEVELOPER. EACH BLAST SHALL BE MONITORED BY A SEISMOGRAPH THAT HAS BEEN CALIBRATED WITHIN THE LAST YEAR.
8. MINERAL EXTRACTION MUST REMAIN FIVE (5) FEET ABOVE THE SEASONAL HIGH WATER TABLE.
9. THE MDEP REQUIRES THAT A NEW TEST WELL BE INSTALLED FOR EVERY FIVE ACRES OF MINERAL EXTRACTION. EACH TIME THE LOCATION OF A NEW TEST WELL IS DETERMINED, THE PLANS MUST BE UPDATED TO DEPICT THE WELL'S PLACEMENT. THE REVISED PLANS MUST BE SUPPLIED TO THE TOWN OF WINDHAM.
10. VEGETATION AT THE INTERSECTION OF NASH ROAD AND HIGHWAY 302 ON THE EAST SIDE MUST BE KEPT CUT BACK AND TRIMMED BELOW 30 INCHES FROM THE EDGE OF PAVEMENT TO THE TOE OF THE SLOPE FOR THE EMBANKMENT ALONG THE SITE'S FRONTAGE.
11. A TRAFFIC COUNT BE CONDUCTED TWO YEARS HENCE AND THE RESULTS SUBMITTED OT THE TOWN OF WINDHAM. THE TRAFFIC COUNT WILL BE CONDUCTED BY A 3RD PARTY, AND SCHEDULED BY THE TOWN. ALL COSTS WILL BE PAID BY THE APPLICANT. A NEW TRAFFIC STUDY WILL BE TRIGGERED IF THE COUNT PEAK IS MORE THAN 36 TRIPS ON NASH ROAD IN AND OUT OF THE QUARRY PER HOUR.
12. THE FORMER ENTRANCE ONTO ROUTE 302 SHALL BE REPLANTED.
13. TEMPORARY FENCING AROUND THE ACTIVE QUARRY AREA, AND PERMANENT FENCING AROUND THE ENTIRE QUARRY PERIMETER ARE NOT REQUIRED BY THE TOWN BEYOND ANY STATE OR FEDERAL REQUIREMENTS.
14. THIS PROJECT MUST HAVE VIBRATION LEVELS IN COMPLIANCE WITH SECTIONS 604(H) AND 606(A) OF THE WINDHAM LAND USE ORDINANCE.
15. YEAR AROUND OPERATIONS OF THE QUARRY ARE PERMITTED. A NOISE TEST SHALL BE CONDUCTED BY THE APPLICANT WITH COORDINATION BY TOWN STAFF IN THE SPRING OF 2011 BEFORE THE LEAVES COME OUT.
16. UTILITY LINES ASSOCIATED WITH THE MAINTENANCE BUILDING SHALL BE INSTALLED UNDERGROUND, PER THE SITE PLAN ORDINANCE.
17. THE FORMER ENTRANCE ONTO ROUTE 302 SHALL BE TIERED, LOAMED AND SEEDED, AND TWO OFFSET ROWS OF 2-FOOT TALL WHITE PINES SHALL BE PLANTED ON THE BERM AT THE TOP OF THE FORMER ENTRANCE NO LATER THAN OCTOBER 15, 2011.
18. THE QUARRY ENTRANCE WILL BE PAVED, THE SECURITY GATE INSTALLED, AND THE STORMWATER POND SHALL BE COMPLETED BY JULY 31, 2011.
19. TEMPORARY FENCING SHALL BE INSTALLED AROUND THE ACTIVE PORTION OF THE QUARRY ON THE BERM. ORANGE SNOW FENCING STAKED EVERY 10 FEET WILL SATISFY THIS CONDITION OF APPROVAL.
20. GROUNDWATER LEVEL AND QUALITY MONITORING WILL BE SUSPENDED UNTIL 1 YEAR PRIOR OF EXCAVATING WITHIN 2 FEET OF THE SEASONALLY HIGH GROUNDWATER TABLE. ONCE REACHED, GROUNDWATER LEVEL AND QUALITY MONITORING WILL RESUME QUARTERLY.
21. WOODWASTE PROCESSING WILL BE ALLOWED AND IN CONFORMANCE WITH THE MAINE DEP PERMIT-BY-RULE WOODWASTE PROCESSING FACILITY PERMIT #S-022491-WK-A-P.

OWNER / APPLICANT:

S.B. FREEPORT, INC.
SHAW BROTHERS CONSTRUCTION, INC.
341 MOSHER ROAD, GORHAM, ME 04038

ENGINEER:

Sebago Technics

Engineering Expertise You Can Build On

One Chobot Street
Westbrook, Me 04098-1339
Tel (207) 856-0277

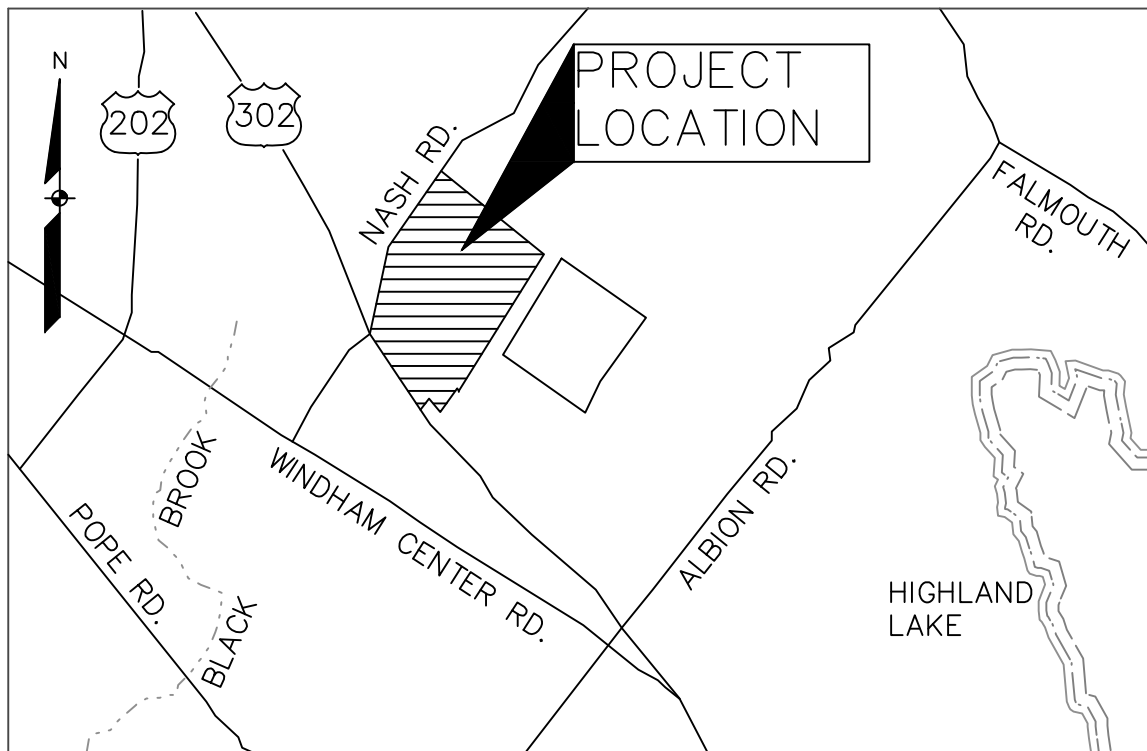

LOCATION MAP

N.T.S.

APPROVED— TOWN OF WINDHAM PLANNING BOARD

DATE
CHAIRPERSON

SHEET INDEX

SHEET NO.	DESCRIPTION
1	COVER SHEET
2	SITE OVERVIEW PLAN
3	AMENDED RECLAMATION PLAN
4	WET POND PLAN — PHASES I & II
5	WET POND PLAN — PHASES III & IV
6	QUARRY SECTIONS
7	DETAILS
8	DETAILS