

APPLICATION FOR POLE LOCATIONS

September 4, 2018

To the Board of Councilors  
of Windham, Maine

NORTHERN NEW ENGLAND TELEPHONE OPERATIONS LLC and CENTRAL MAINE POWER COMPANY respectfully request(s) permission for a location for poles and cables and wires thereon, including the necessary sustaining, supporting and protecting fixtures in, along, upon and across the following named public streets and highways:

IN THE TOWN OF WINDHAM, MAINE

Swett Road - Placement of new Pole 14 ½ [31H] approximately 2820 feet Southerly of the intersection with center line of Town Farm road, one pole

THIS APPLICATION IS BEING SUBMITTED WITHOUT PUBLIC NOTICE BY PUBLICATION

Said poles to be erected substantially in accordance with the plan filed herewith marked Consolidated No. 324063 dated August 24, 2018 and shall be of wood or other suitable material, and the cables and wires shall be run at the height in compliance with standards of the National Electrical Safety Code at highway crossings and elsewhere for electric cables and wires, and (or) for telephone cables and wires. All cables and wires to be maintained in accordance with standards of the National Electrical Safety Code.

NORTHERN NEW ENGLAND TELEPHONE  
OPERATIONS LLC

By

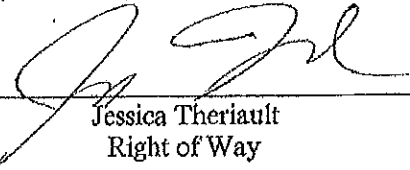
  
Jessica Theriault  
Right of Way

CENTRAL MAINE POWER COMPANY

By

  
Herb Stevens  
Supervisor - Integrated Field Design

**PERMIT FOR POLE LOCATIONS**

**To the Board of Councilors  
Windham, Maine**

**ORDERED:** That **NORTHERN NEW ENGLAND TELEPHONE OPERATIONS LLC** and **CENTRAL MAINE POWER COMPANY** be and is/are hereby authorized and permitted to erect and maintain poles and cables and wires to be placed thereon, together with such sustaining, supporting and protecting fixtures as said companies may deem requisite, in, along, upon and across the public streets and highways of said **Town of Windham** as hereinafter designated, as requested in application of said companies dated the 4<sup>th</sup> day of September, 2018.

All construction under this permit shall be in accordance with the following specifications: The poles shall be located between the vehicular traveled section of the way and the limits of the highway, shall be set firmly in the ground, substantially at locations indicated upon the plan marked Fairpoint No. **324063** dated **August 24, 2018** filed with said application, and shall be of wood or other suitable material, and the cables and wires shall be run at the height in compliance with standards of the National Electrical Safety Code at highway crossings and elsewhere for electric cables and wires, and (or) for telephone cables and wires.

All cables and wires to be maintained in accordance with standards of the National Electrical Safety Code.

Following are the public streets and highways above referred to:

**Swett Road – Placement of new Pole 14 ½ [31H] approximately 2820 feet Southerly of the intersection with center line of Town Farm road, one pole**

**THIS PERMIT IS BEING GRANTED WITHOUT PUBLIC NOTICE BY PUBLICATION**

It is further adjudged and voted that satisfactory proof of validity of the applicant's notice or procedures required by statute has been given upon the application of said companies to erect poles with the cables and wires thereon in, along, upon and across the public streets and highways of **Windham**, Maine, designated by this permit.

**Board of Councilors**



**PERMIT GRANTED**

\_\_\_\_\_, 2018

This permit is recorded in the Records of the \_\_\_\_\_ of \_\_\_\_\_,  
Book \_\_\_\_\_, Page \_\_\_\_\_

\_\_\_\_\_  
Town Clerk

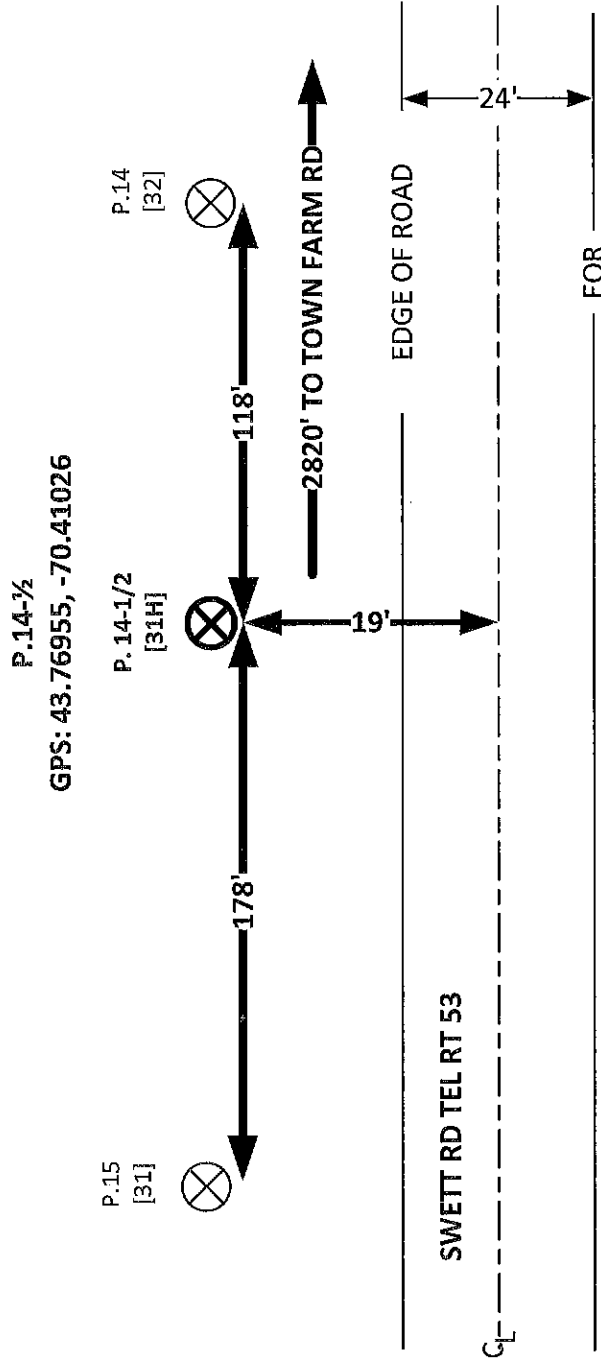
FAIRPOINT No. 324063 MUNICIPALITY WINDHAM, ME DATE 8/24/2018  
 PLAN FOR PROPOSED POLE LOCATION FOR NEW SERVICES



**TEL TO PLACE NEW MID-SPAN POLE 14-½ 40FT CL 3 SPP FOR  
 NEW ELCO POWER AND TEL SERVICES.(1C).**

ALL PLANT IS LOCATED WITHIN HIGHWAY LIMITS

<b>LEGEND</b>		<b>NO SCALE</b>	
● = POLE LOCATION	FAIRPOINT	NO.	DOT NO.
⊗ = POLE LOCATION- JOINT WITH	CMP	PREPARED BY	PATRICK MORRISON
X = POLE		CHECKED BY	
⊔ = CENTER LINE		PUBLISH	
EOP = EDGE OF PAVEMENT		NON-PUBLISH	
POWER CO. =	VOLTS		
[ XX ] = CMP POLE NUMBER		PERMIT BY RULE <input checked="" type="checkbox"/>	
PHASE TEL. CO. = AERIAL FIBER OPTIC CABLE		STATUTORY PROCEDURE <input type="checkbox"/>	
DISTANCES SHOWN ARE APPROXIMATE AND ALL SPANS MEASURED ALONG APPLICANT'S CONSTRUCTION CENTERLINE			

