

APPLICATION FOR POLE LOCATIONS

August 2, 2019

To the Board of Councilors
of Windham, Maine

CONSOLIDATED COMMUNICATIONS OF NORTHERN NEW ENGLAND
COMPANY, LLC and CENTRAL MAINE POWER COMPANY respectfully request(s) permission
for a location for poles and cables and wires thereon, including the necessary sustaining, supporting and
protecting fixtures in, along, upon and across the following named public streets and highways:

IN THE TOWN OF WINDHAM, MAINE

Roosevelt Trail / State Rte 302 – Placement of new Pole 23 ½ [183H] approximately 375 feet
Northwesterly of the intersection with center line of Varney Mills Road, one pole

THIS APPLICATION IS BEING SUBMITTED WITHOUT PUBLIC NOTICE BY PUBLICATION

Said poles to be erected substantially in accordance with the plan filed herewith marked
Consolidated No. 332337 dated July 24, 2019 and shall be of wood or other suitable material, and the
cables and wires shall be run at the height in compliance with standards of the National Electrical Safety
Code at highway crossings and elsewhere for electric cables and wires, and (or) for telephone cables and
wires. All cables and wires to be maintained in accordance with standards of the National Electrical
Safety Code.

CONSOLIDATED COMMUNICATIONS OF
NORTHERN NEW ENGLAND COMPANY LLC

By

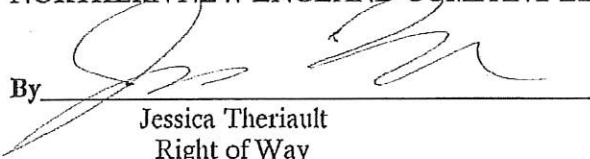
Jessica Theriault
Right of Way

CENTRAL MAINE POWER COMPANY

By

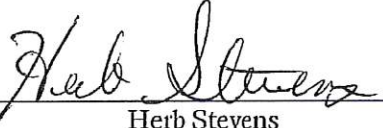
Herb Stevens
Supervisor – Integrated Field Design

PERMIT FOR POLE LOCATIONS

To the Board of Councilors
Windham, Maine

ORDERED: That **CONSOLIDATED COMMUNICATION OF NORTHERN NEW ENGLAND COMPANY LLC** and **CENTRAL MAINE POWER COMPANY** be and is/are hereby authorized and permitted to erect and maintain poles and cables and wires to be placed thereon, together with such sustaining, supporting and protecting fixtures as said companies may deem requisite, in, along, upon and across the public streets and highways of said **Town of Windham** as hereinafter designated, as requested in application of said companies dated the 2nd day of August, 2019.

All construction under this permit shall be in accordance with the following specifications: The poles shall be located between the vehicular traveled section of the way and the limits of the highway, shall be set firmly in the ground, substantially at locations indicated upon the plan marked Consolidated No. 332337 dated July 24, 2019 filed with said application, and shall be of wood or other suitable material, and the cables and wires shall be run at the height in compliance with standards of the National Electrical Safety Code at highway crossings and elsewhere for electric cables and wires, and (or) for telephone cables and wires.

All cables and wires to be maintained in accordance with standards of the National Electrical Safety Code.

Following are the public streets and highways above referred to:

Roosevelt Trail / State Rte 302 – Placement of new Pole 23 ½ [183H] approximately 375 feet Northwesterly of the intersection with center line of Varney Mills Road, one pole

THIS PERMIT IS BEING GRANTED WITHOUT PUBLIC NOTICE BY PUBLICATION

It is further adjudged and voted that satisfactory proof of validity of the applicant's notice or procedures required by statute has been given upon the application of said companies to erect poles with the cables and wires thereon in, along, upon and across the public streets and highways of **Windham**, Maine, designated by this permit.

Board of Councilors

1. _____

4. _____

2. _____

5. _____

3. _____

6. _____

PERMIT GRANTED

7. _____

8-13, 2019

This permit is recorded in the Records of the Town Clerk of Windham,
Book _____, Page _____

Town Clerk

FAIRPOINT NO. 332337 MUNICIPALITY WINDHAM, ME DATE 7/24/2019
PLAN FOR PROPOSED POLE LOCATION FOR NEW SERVICES



P.37-1/2
GPS: 43.811917, -70.421231

375' TO VARNEYS MILLS RD

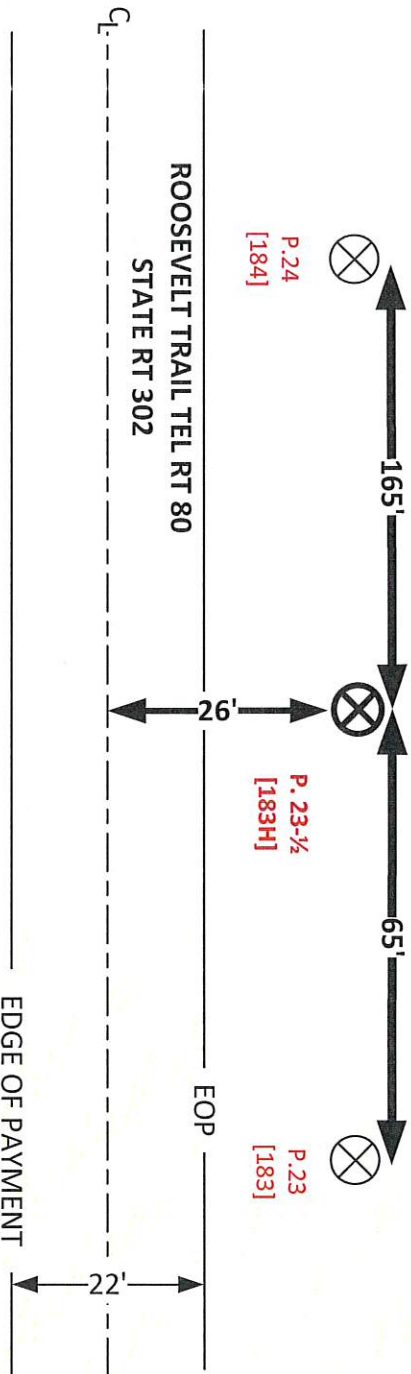

CMP EON# 801000247602
TEL MEMO # 19-MEI-102476

TEL TO PLACE NEW MID-SPAN POLE 23-1/2 45FT CL 3 SPP FOR
NEW ELCO POWER SERVICES.

ALL PLANT IS LOCATED WITHIN HIGHWAY LIMITS

LEGEND
● = POLE LOCATION CCI
⊗ = POLE LOCATION-- JOINT WITH CMP
X = POLE
CL = CENTER LINE
EOP = EDGE OF PAYMENT
POWER CO. =

⊗ = PEDISTAL POST LOCATION
WS = WARNING SIGN LOCATION
MH = MANHOLE LOCATION
= BURIED CABLE/CONDUIT LOCATION
[XX] = CMP POLE NUMBER
PHASE TEL. CO. = AERIAL FIBER OPTIC CABLE
DISTANCES SHOWN ARE APPROXIMATE AND ALL SPANS MEASURED ALONG APPLICANT'S CONSTRUCTION CENTERLINE

NO SCALE

DOT NO.

NO.

PREPARED BY PATRICK MORRISON

CHECKED BY

PUBLISH

NON-PUBLISH

PERMIT BY RULE

STATUTORY PROCEDURE

PERMIT BY RULE

STATUTORY PROCEDURE

