

FRONT ELEVATION
1/4" = 1'-0"

CONSTRUCTION NOTE:
CONTRACTOR IS TO VERIFY GRADE AND ALL DIMENSIONS IN FIELD BEFORE CONSTRUCTION. DIMENSIONS SHOWN ARE FOR INFORMATIONAL PURPOSES ONLY. IF DIMENSIONS AND SPECIFICATIONS ARE NOT VERIFIED BY CLIENT AND/OR CONTRACTOR BEFORE ACTUAL CONSTRUCTION BEGINS, DRAFTING & DESIGN ME, LLC WILL BE HELD HARMLESS. DRAFTING & DESIGN ME, LLC ASSUMES NO LIABILITY FOR CHANGES AND/OR REVISIONS MADE TO PLAN BY CLIENT AND/OR CONTRACTOR.



Cook Road Condo
PRELIMINARY DRAWINGS
Windham, ME

DRAWINGS ARE PROVIDED FOR INFORMATIONAL/PERMITTING PURPOSES ONLY. IF USED FOR CONSTRUCTION, THE CONTRACTOR ASSUMES ALL RESPONSIBILITY FOR LOCAL CODE COMPLIANCE. ALL DRAWINGS, PLANS, SKETCHES ECT. ARE PROVIDED TO OUR CLIENTS BASED UPON INFORMATION PROVIDED BY THE CLIENT AND DRAWN IN ACCORDANCE WITH COMMON BUILDING PRACTICES AND LOCAL CODES. NONE OF THE EMPLOYEES OF DRAFTING & DESIGN ME, LLC ARE REGISTERED ARCHITECTS, ENGINEERS OR LAND SURVEYORS. ALL DIMENSIONS AND SPECIFICATIONS SHOULD BE VERIFIED BY CLIENT, CONTRACTOR, ARCHITECT AND/OR CODE OFFICER BEFORE ACTUAL CONSTRUCTION BEGINS. IF DIMENSIONS AND SPECIFICATIONS ARE NOT VERIFIED BY CLIENT AND/OR CONTRACTOR BEFORE ACTUAL CONSTRUCTION BEGINS DRAFTING & DESIGN ME, LLC WILL BE HELD HARMLESS. DRAFTING & DESIGN ME, LLC ASSUMES NO LIABILITY FOR CHANGES AND/OR REVISIONS MADE TO PLAN BY CLIENT AND/OR CONTRACTOR.

REVISIONS:	
02/26/19	REVISED PLANS
Date : 02/26/19	
Scale : 1/4"=1'-0"	
Drawn By: JTM	
Project: 0121518	
Sheet Number:	
1 of 2	

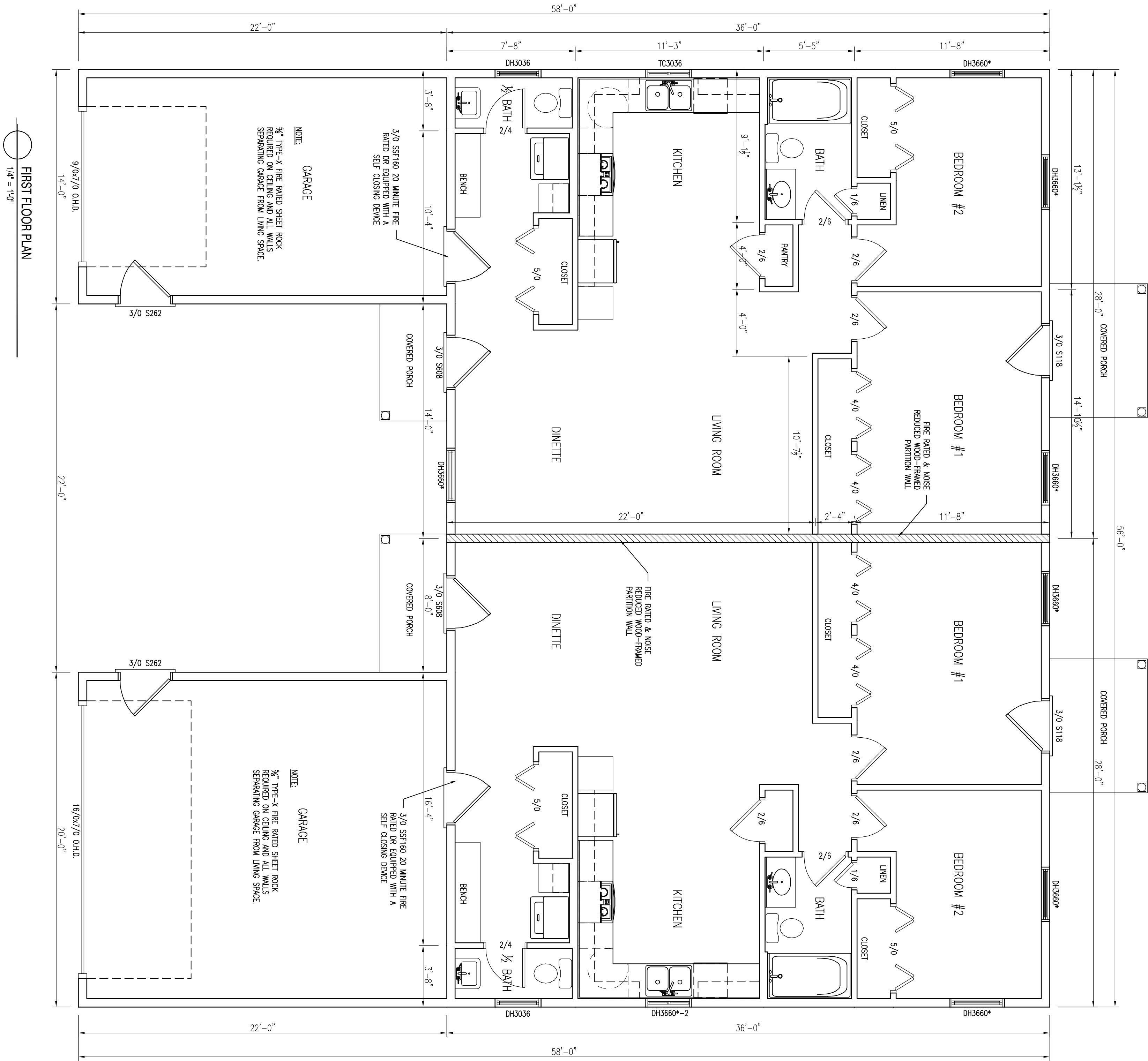

- SMOKE ALARMS**
- SHALL BE INTERCONNECTED & INSTALLED IN THE FOLLOWING LOCATIONS
1. EACH SLEEPING AREA
 2. OUTSIDE EACH SEPARATE SLEEPING AREA IN THE IMMEDIATE VICINITY OF THE BEDROOMS
 3. ON EACH ADDITIONAL STORY OF THE DWELLING INCLUDING BASEMENTS
 4. BETWEEN FLOORS, WHEREVER REQUIRED, 3/4" THICK GLASS AT ALL HAZARDOUS SPACES, INCLUDING CEILING JOINTS & CEILINGS SEPARATING FLOORS, WHEREVER REQUIRED, PER TOWN AND LOCAL CODE
- * DENOTES EGRESS WINDOW
- DH DENOTES WINDOW TYPE & ROUGH OPENINGS DIMENSIONS/SLIT GLASS AT ALL HAZARDOUS SPACES, INCLUDING CEILING JOINTS & CEILINGS SEPARATING FLOORS, WHEREVER REQUIRED, PER TOWN AND LOCAL CODE
- GENERAL WORKMANSHIP ALARMS**
- SHALL BE INSTALLED IN THE FOLLOWING LOCATIONS
1. OUTSIDE EACH SEPARATE SLEEPING AREA IN THE IMMEDIATE VICINITY OF THE BEDROOMS
 2. IN THE IMMEDIATE VICINITY OF THE BEDROOMS IN THE IMMEDIATE VICINITY OF THE BEDROOMS
- CONSTRUCTION NOTE:**
- CONTRACTOR TO VERIFY SCALE IN FIELD AND ALL DIMENSIONS SHALL BE VERIFIED BY CONTRACTOR. DIMENSIONS SHOWN MAY DIFFER FROM ACTUAL FINISHED CONSTRUCTION. FINAL MATERIALS, WINDOW/DOOR LOCATIONS AND SIZES TO BE DETERMINED PER OWNER/CONTRACTOR OR LOCAL CODES.

Cook Road Condo
PRELIMINARY DRAWINGS
Windham, ME



Revisions:

02/26/19 REVISIONS

Date : 02/26/19

Scale : 1/4"=1'-0"

Drawn By: JTM

Project: 0121518

Sheet Number: