

# CMP WORK SKETCH SHEET

Customer: Robie Builders	Date: 10-29-19
Phone #: 207 572 7330	CMP W/O#: 103 006 14464
Town: Windham	
Street: River RD	
Takeoff Pole: 14	

REMARKS:

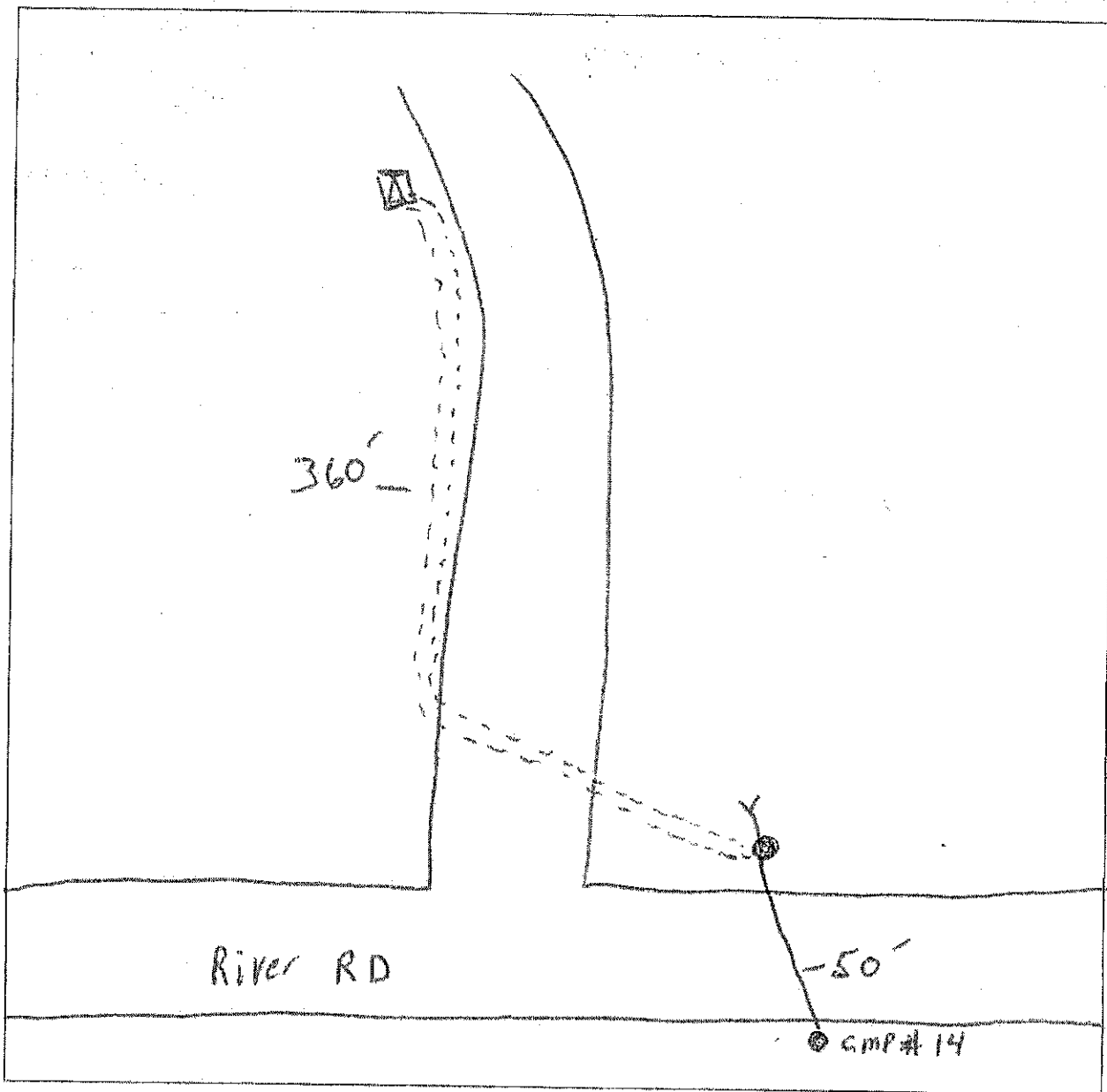

Date: 10-27-17

Customer Name: Robic Builders

Telephone # 207 572 7330

Job Location: Windham

Work Order #: 103006 14464

## MATERIAL LIST

	Quantity	Length
Pole	1	40
Pole Tops		
Insulators Pole Top 15 KVA		
Insulators Dead End 15 KVA	1	
Dead End Shoes 1/0	2	
10" Bolts		
12" Bolts		
2" Washers		
3" Washers		
Spring Washers		
Connectors Aluminum	6	
Connectors Copper	6	
10" Eye Bolts	1	
12" Eye Bolts	1	
Neutral Brackets		
Guy Guards	1	
Guy Hooks/Strain rod	1	
Guy Wire 3/8		40
Anchor Rods & Plates	1	
Rod Bonding Clamps	1	
#4 Copper Wire		60'-
#2 Copper Wire		12'-
1/0 AAAC Aluminum Wire		100'-
Tie Wire Aluminum		
#2 Primary URD 15 KVA		720'-
Elbows Load brake 15 KVA	2	
Seal Kits	2	
Terminators 15 KVA	2	
Lightening Arrestors	2	
Cutouts 15 KVA	2	
Equipment Mounting Brackets	2	
Cable Positioning Brackets	2	
Ground Rods	2	
Other		
Other		

## PRIVATE POWER SERVICES

SACQ MAINE

## APPLICATION FOR POLE LOCATION OR UNDERGROUND LOCATION

In the Town of: Windham Maine☐ City☒ Town of Windham Maine☐ Country☐ Private Power Services hereby applies for permission to:☐ Construct and maintain together with attached facilities and appurtenances upon, along, or across certain streets in said city/town as described below.☐ Construct and maintain buried cables, conduits, manholes, and handholds, together with wire and cables, transformers, cutouts, and other equipment therein, under, Along, and across certain streets and highways in said city/town as described below:☒ Private Power Services hereby applies for permission to construct a pole line together with attached facilities and appurtenances upon, along or across certain streets in said town as described below:1.) Starting point: ☒ Pole # 142.) Road: River RD3.) Directions: South4.) Distance: 50' AWAY FROM P1 145.) Number of poles: 1 Pole

6.) Overhead wires and cables shall have a minimum clearance of 18 feet over public highway, and be constructed to conform to the requirements of the National Electrical Safety Code.

☐ Buried cable facilities shall be placed at a minimum depth of 26" under pavement and 30" elsewhere and be constructed to the requirements of the National Electrical Safety Code.

Any persons, firm or corporation claiming to be adversely affected by this proposed location shall file a written objection with the D.O.T., City, Town, and Country stating the cause of said objection within fourteen (14) days after the publication of this notice or ninety (90) days after installation of facilities without publication.

☐ Public Notice of this Application has been given by publishing the text of the same in \_\_\_\_\_ on \_\_\_\_\_ ☒ not published☐ Approved by Town Hall

By: \_\_\_\_\_

Date: \_\_\_\_\_

Private Power Services: \_\_\_\_\_

Signature

Date: 10-29-19