



REPLY TO
ATTENTION OF

DEPARTMENT OF THE ARMY
NEW ENGLAND DISTRICT, CORPS OF ENGINEERS
696 VIRGINIA ROAD
CONCORD, MASSACHUSETTS 01742-2751

MAINE GENERAL PERMITS (GPs)
AUTHORIZATION LETTER AND SCREENING SUMMARY

MICHELLE CARPENTER
TPE ME WH02, LLC
747 SOUTH CORONA STREET, SUITE 100
DENVER, COLORADO 80209

CORPS PERMIT # NAE-2020-03015
CORPS GP# 13
STATE ID# NRPA

DESCRIPTION OF WORK:

Place permanent fill in approximately 5,741 SF of freshwater wetland off Swett Road at Windham, Maine in order to construct an access road for a 19.9 acre solar array. This work is shown on the attached plans entitled "SITE LOCATION PLAN", "ACOE 1: Existing Conditions Plan", and "ACOE 2: Proposed Site Plan" in three sheets dated "November 2020" and "Overall Site Layout Plan C2.0" in one sheet dated "11/18/2020".

See GENERAL CONDITIONS attached.

LAT/LONG COORDINATES: 43.765060° N -70.401321° W USGS QUAD: NORTH WINDHAM, ME

I. CORPS DETERMINATION:

Based on our review of the information you provided, we have determined that your project will have only minimal individual and cumulative impacts on waters and wetlands of the United States. **Your work is therefore authorized by the U.S. Army Corps of Engineers under the Federal Permit, the Maine General Permits (GPs) which can be found at: <https://www.nae.usace.army.mil/Missions/Regulatory/State-General-Permits/Maine-General-Permit/>** Accordingly, we do not plan to take any further action on this project.

You must perform the activity authorized herein in compliance with all the terms and conditions of the GP [including any attached Additional Conditions and any conditions placed on the State 401 Water Quality Certification including any required mitigation]. Please review the enclosed GPs, including the GPs conditions beginning on page 5, to familiarize yourself with its contents. You are responsible for complying with all of the GPs requirements; therefore you should be certain that whoever does the work fully understands all of the conditions. You may wish to discuss the conditions of this authorization with your contractor to ensure the contractor can accomplish the work in a manner that conforms to all requirements.

If you change the plans or construction methods for work within our jurisdiction, please contact us immediately to discuss modification of this authorization. This office must approve any changes before you undertake them.

Condition 45 of the GPs (page 19) provides one year for completion of work that has commenced or is under contract to commence prior to the expiration of the GPs on October 14, 2025. You will need to apply for reauthorization for any work within Corps jurisdiction that is not completed by October 14, 2026.

This authorization presumes the work shown on your plans noted above is in waters of the U.S. Should you desire to appeal our jurisdiction, please submit a request for an approved jurisdictional determination in writing to the undersigned.

No work may be started unless and until all other required local, State and Federal licenses and permits have been obtained. **This includes but is not limited to a Flood Hazard Development Permit issued by the town if necessary.**

II. STATE ACTIONS: PENDING [X], ISSUED [], DENIED [] DATE _____

APPLICATION TYPE: PBR: _____, TIER 1: X, TIER 2: _____, TIER 3: _____, LURC: _____, DMR LEASE: _____, NA: _____

III. FEDERAL ACTIONS:

JOINT PROCESSING MEETING: non-screen LEVEL OF REVIEW: SELF-VERIFICATION: X PRE-CONSTRUCTION NOTIFICATION: _____

AUTHORITY (Based on a review of plans and/or State/Federal applications): SEC 10 _____, 404 X 10/404 _____, 103 _____

EXCLUSIONS: The exclusionary criteria identified in the general permit do not apply to this project.

FEDERAL RESOURCE AGENCY OBJECTIONS: EPA N/A, USF&WS N/A, NMFS N/A

If you have any questions on this matter, please contact my staff at 978-318-8676 at our Augusta, Maine Project Office. In order for us to better serve you, we would appreciate your completing our Customer Service Survey located at: http://corpsmapu.usace.army.mil/cm_apex/f?p=136:4:0

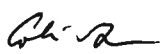
COLIN M. GREENAN
PROJECT MANAGER
MAINE PROJECT OFFICE

 12/23/2020
FOR FRANK J. DEL GIUDICE DATE
CHIEF, PERMITS & ENFORCEMENT BRANCH
REGULATORY DIVISION



US Army Corps
of Engineers[®]
New England District

PLEASE NOTE THE FOLLOWING GENERAL AND SPECIAL CONDITIONS FOR
DEPARTMENT OF THE ARMY
MAINE GENERAL PERMIT 13
PERMIT NO. NAE-2020-03015

GENERAL CONDITIONS

23. Soil Erosion, Sediment, and Turbidity Controls: a. Adequate sedimentation and erosion control management measures, practices and devices, such as phased construction, installation of sediment control barriers (i.e. silt fence, vegetated filter strips, geotextile silt fences, erosion control mixes, hay bales or other devices) downhill of all exposed areas, retention of existing vegetated buffers, application of temporary mulching during construction, and permanent seeding and stabilization shall be installed and properly maintained to reduce erosion and retain sediment on-site during and after construction. They shall be capable of preventing erosion; of collecting sediment, suspended and floating materials; and of filtering fine sediment. b. Temporary sediment control barriers shall be removed upon completion of work, but not until all disturbed areas are permanently stabilized. The sediment collected by these sediment barriers shall be removed and placed at an upland location and stabilized to prevent its later erosion into a waterway or wetland. All exposed soil and other fills shall be permanently stabilized at the earliest practicable date.

33. Permit(s)/Authorization Letter On-Site. The permittee shall ensure that a copy of the terms and conditions of these GPs and any accompanying authorization letter with attached plans are at the site of the work authorized by these GPs whenever work is being performed and that all construction personnel performing work which may affect waters of the U.S. are fully aware of the accompanying terms and conditions. The entire permit authorization shall be made a part of any and all contracts and subcontracts for work that affects areas of Corps jurisdiction at the site of the work authorized by these GPs. This shall be achieved by including the entire permit authorization in the specifications for work. The term "entire permit authorization" means all terms and conditions of the GPs, the GPs, and the authorization letter (including its drawings, plans, appendices and other attachments) and subsequent permit modifications as applicable. If the authorization letter is issued after the construction specifications, but before receipt of bids or quotes, the entire permit authorization shall be included as an addendum to the specifications. If the authorization letter is issued after receipt of bids or quotes, the entire permit authorization shall be included in the contract or subcontract. Although the permittee may assign various aspects of the work to different contractors or subcontractors, all contractors and subcontractors shall be obligated by contract to comply with all environmental protection provisions contained within the entire GP authorization,

34. Inspections. The permittee shall allow the Corps to make periodic inspections at any time deemed necessary in order to ensure that the work is eligible for authorization under these GPs, is being, or has been performed in accordance with the terms and conditions of these GPs.

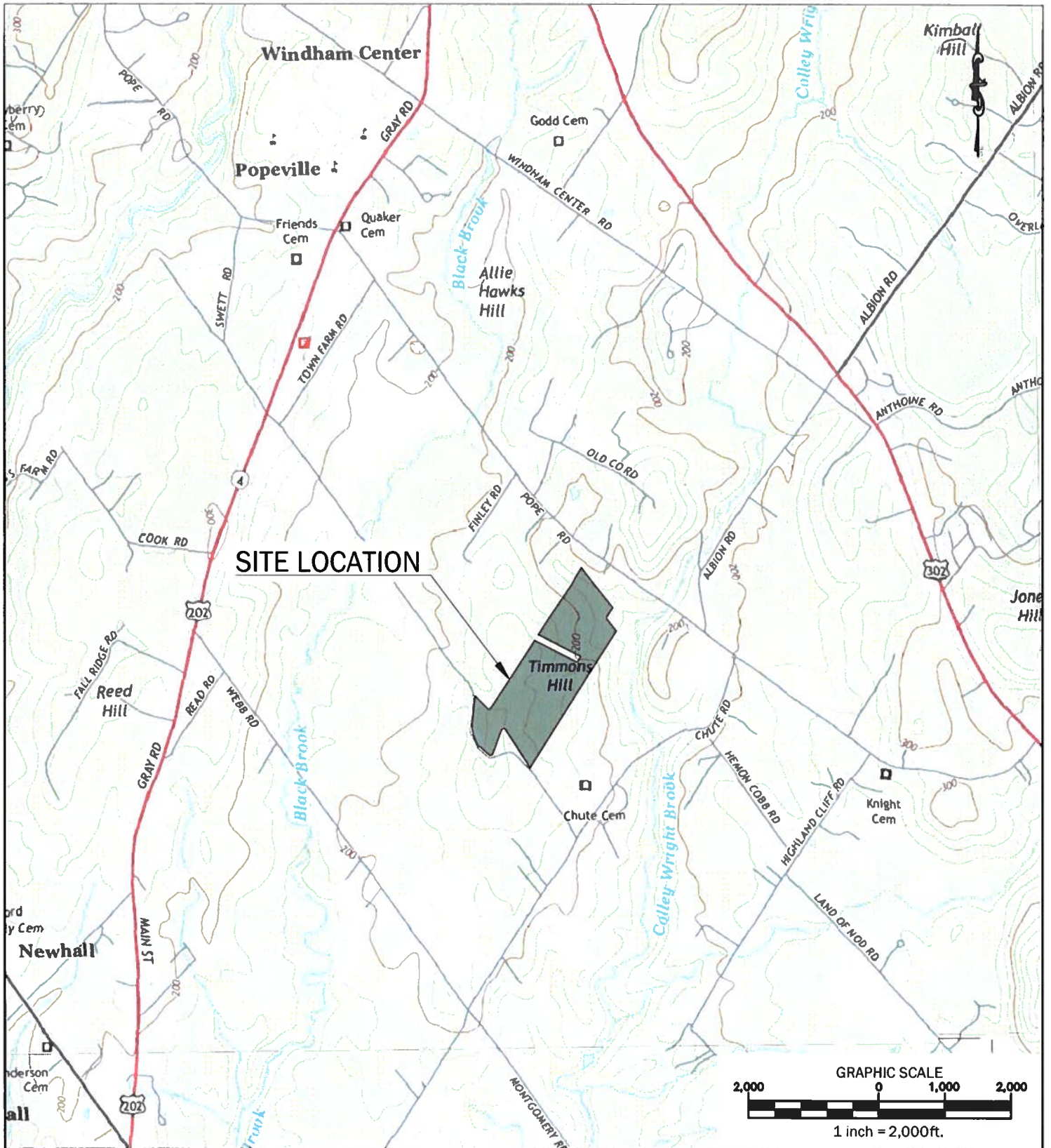

WALSH
ENGINEERING ASSOCIATES, INC.

One Karen Dr., Suite 2A | Westbrook, Maine 04092
ph. 207.553.9898 | www.walsh-eng.com

Copyright © 2020

WH02 Solar Project

Map 6, Lot 60
Swett Road
Windham, Maine 04062

Sheet Title:

SITE LOCATION PLAN

Job No.: 672

Date: November 2020

Scale: 1" = 2,000'

Drawn: TFG

Checked: SWC

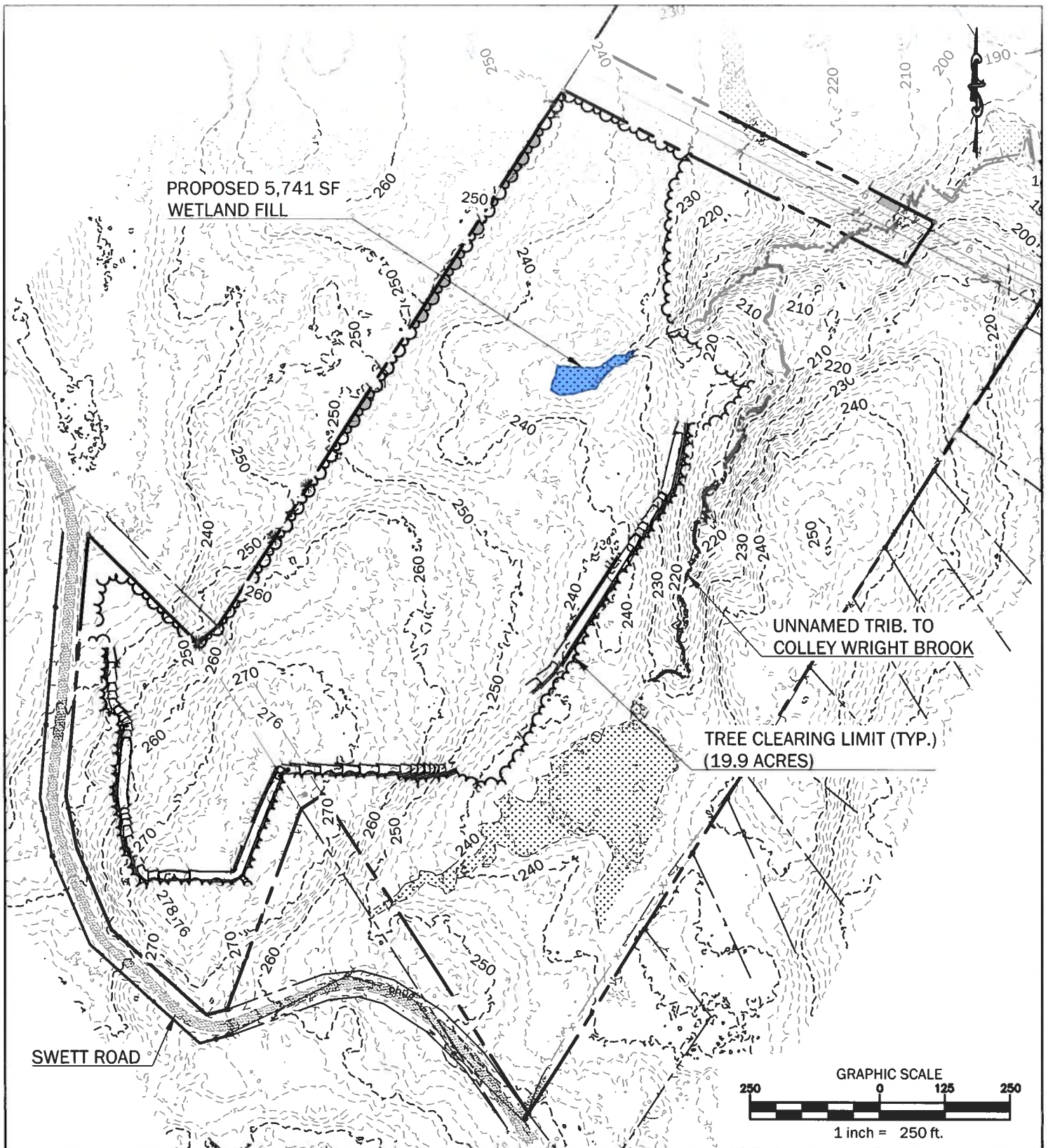

WALSH
ENGINEERING ASSOCIATES, INC.

One Karen Dr., Suite 2A | Westbrook, Maine 04092
ph: 207.553.9898 | www.walsh-eng.com

Copyright © 2020

WH02 Solar Project

Map 6, Lot 60
Swett Road
Windham, Maine 04062

Sheet Title:

**ACOE 1: Existing
Conditions Plan**

Job No.: 672

Date: November 2020

Scale: 1" = 250'

Drawn: CAR

Checked: SWC

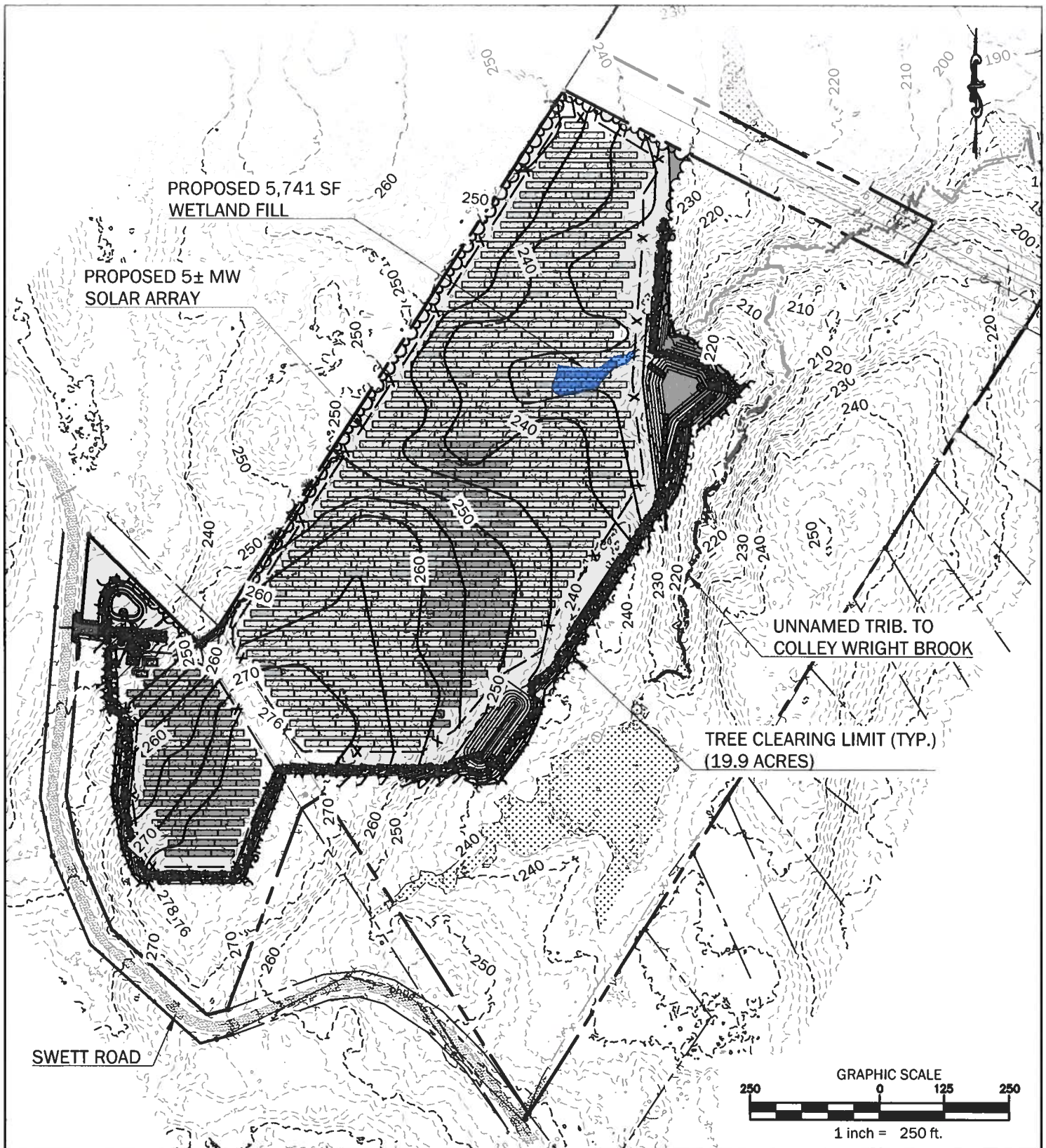

WALSH
ENGINEERING ASSOCIATES, INC.

One Karen Dr., Suite 2A | Westbrook, Maine 04092
ph: 207.553.9898 | www.walsh-eng.com

Copyright © 2020

WH02 Solar Project

Map 6, Lot 60
Swett Road
Windham, Maine 04062

Sheet Title:

**ACOE 2: Proposed
Site Plan**

Job No.: 672

Date: November 2020

Scale: 1" = 250'

Drawn: CAR

Checked: SWC